

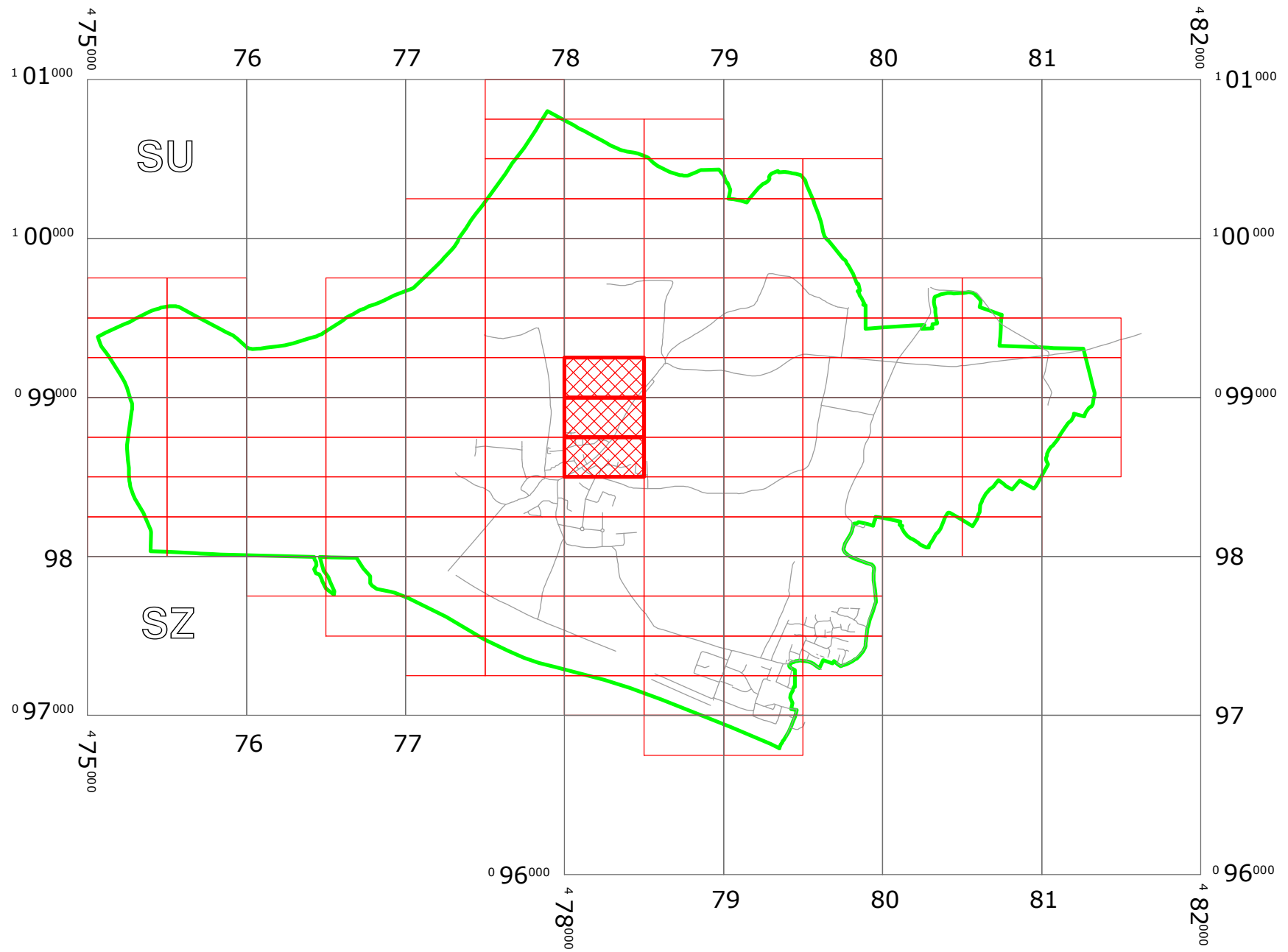



WEST SUSSEX COUNTY COUNCIL  
((CHICHESTER) (PARKING PLACES AND TRAFFIC REGULATION)  
(CONSOLIDATION) ORDER 2010)  
(ROOKWOOD ROAD AMENDMENT) ORDER 2018

# WEST WITTERING: LOCATION OF WAITING RESTRICTIONS



**KEY:**

-  OS.TILE GRID
-  PARKING TILE GRID
-  LOCATION OF WAITING RESTRICTIONS
-  PARISH BOUNDARY
-  ROAD NETWORK



West Sussex County Council  
 Highways & Transport  
 The Grange  
 Tower Street  
 Chichester  
 West Sussex  
 PO19 1RH

WEST SUSSEX COUNTY COUNCIL  
 ((CHICHESTER)  
 (PARKING PLACES AND TRAFFIC REGULATION)  
 (CONSOLIDATION) ORDER 2010)  
 (ROOKWOOD ROAD AMENDMENT) ORDER 2018  
 LOCATION OF WAITING RESTRICTIONS



Reproduced from or based upon 2017 Ordnance Survey mapping with permission of the Controller of HMSO (c) Crown Copyright reserved.  
 Unauthorised reproduction infringes Crown copyright and may lead to prosecution or civil proceedings  
 West Sussex County Council Licence No. 100023447

SCALE: 1:35000  
 DATE: 03/12/2018

### Key for Waiting Restrictions

All areas over which the provision of the orders apply are defined by the shaded areas as shown on the following plans plus a contiguous area not indicated on the plans of verge and/or footway between the carriageway edge and the highway boundary. The plans in this schedule are based upon grid references of the Ordnance Survey National Grid defined by the OSGB 36 triangulation.

#### Prohibition of waiting at any time

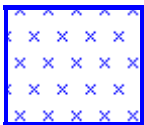
- |     |   |         |                                       |
|-----|---|---------|---------------------------------------|
| 101 |  | check   | No waiting at any time                |
| 120 |  | usgs712 | No waiting 8.00am-8.00pm 01Apr-30Sept |

#### Free Limited Waiting

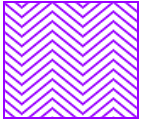
- |     |   |          |  |
|-----|---|----------|--|
| 737 |  | herring2 | Waiting limited to 1hr No return within 1hr<br>7.00am-6.00pm any day |
|-----|---|----------|--|

#### Clearways

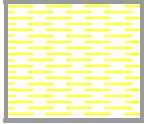
- |      |   |         |   |
|------|---|---------|---|
| 1104 |  | usgs620 | Bus stop clearway 7.00am-7.00pm any day |
|------|---|---------|---|



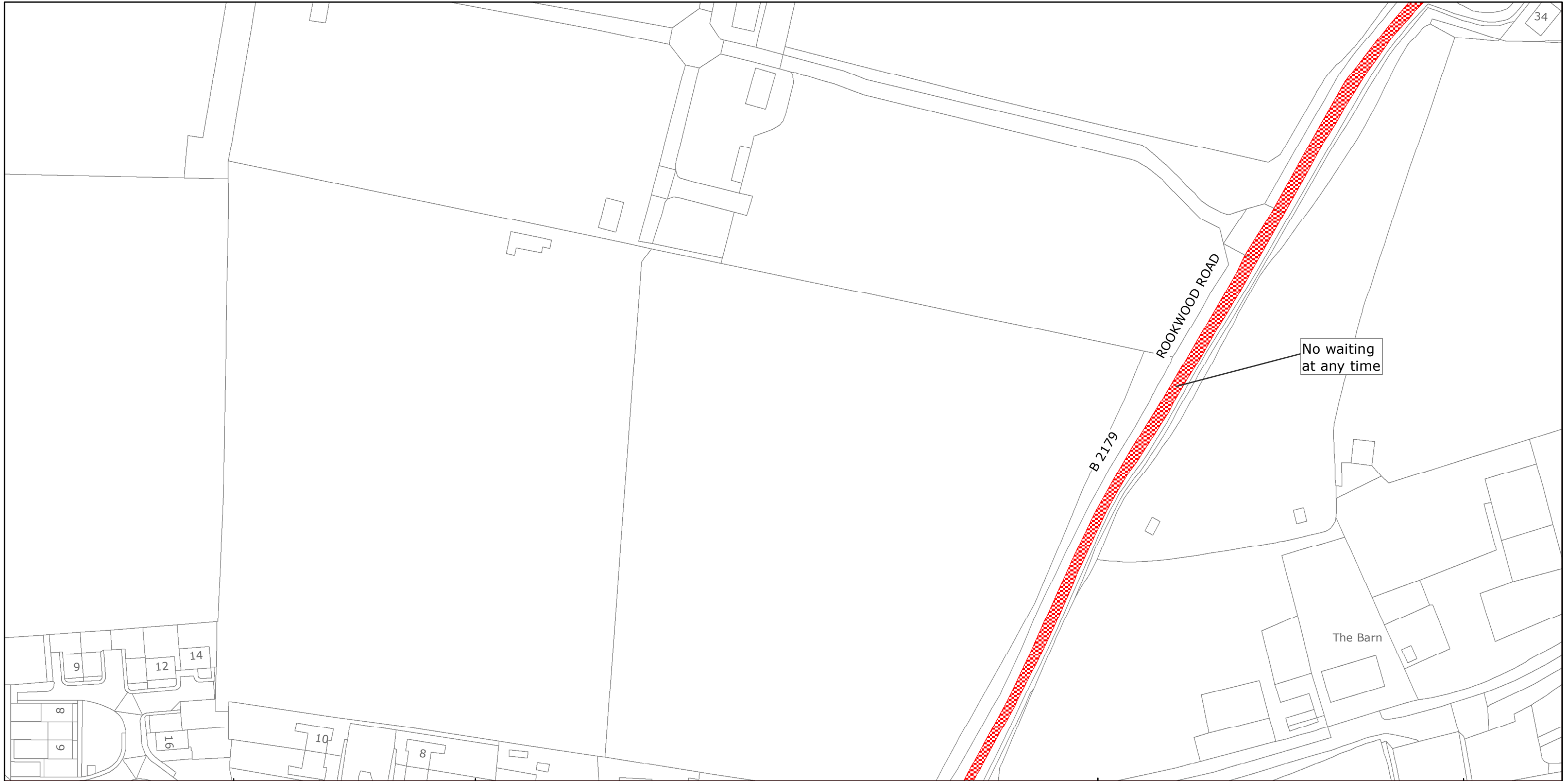

West Sussex County Council  
 Highways & Transport  
 The Grange  
 Tower Street  
 Chichester  
 West Sussex  
 PO19 1RH

CHICHESTER DISTRICT: WEST WITTERING  
 WAITING RESTRICTIONS

**TILE REF NO:**  
**SZ7898NWN**

SHEET ISSUE NO 1  
 SHEET ACTIVE FROM - 03/12/2018



SCALE:  
 1:1250  
 at A3 size

Reproduced from or based upon 2018 Ordnance Survey mapping with permission of the Controller of HMSO (c) Crown Copyright reserved. Unauthorised reproduction infringes Crown copyright and may lead to prosecution or civil proceedings West Sussex County Council Licence No. 100018485

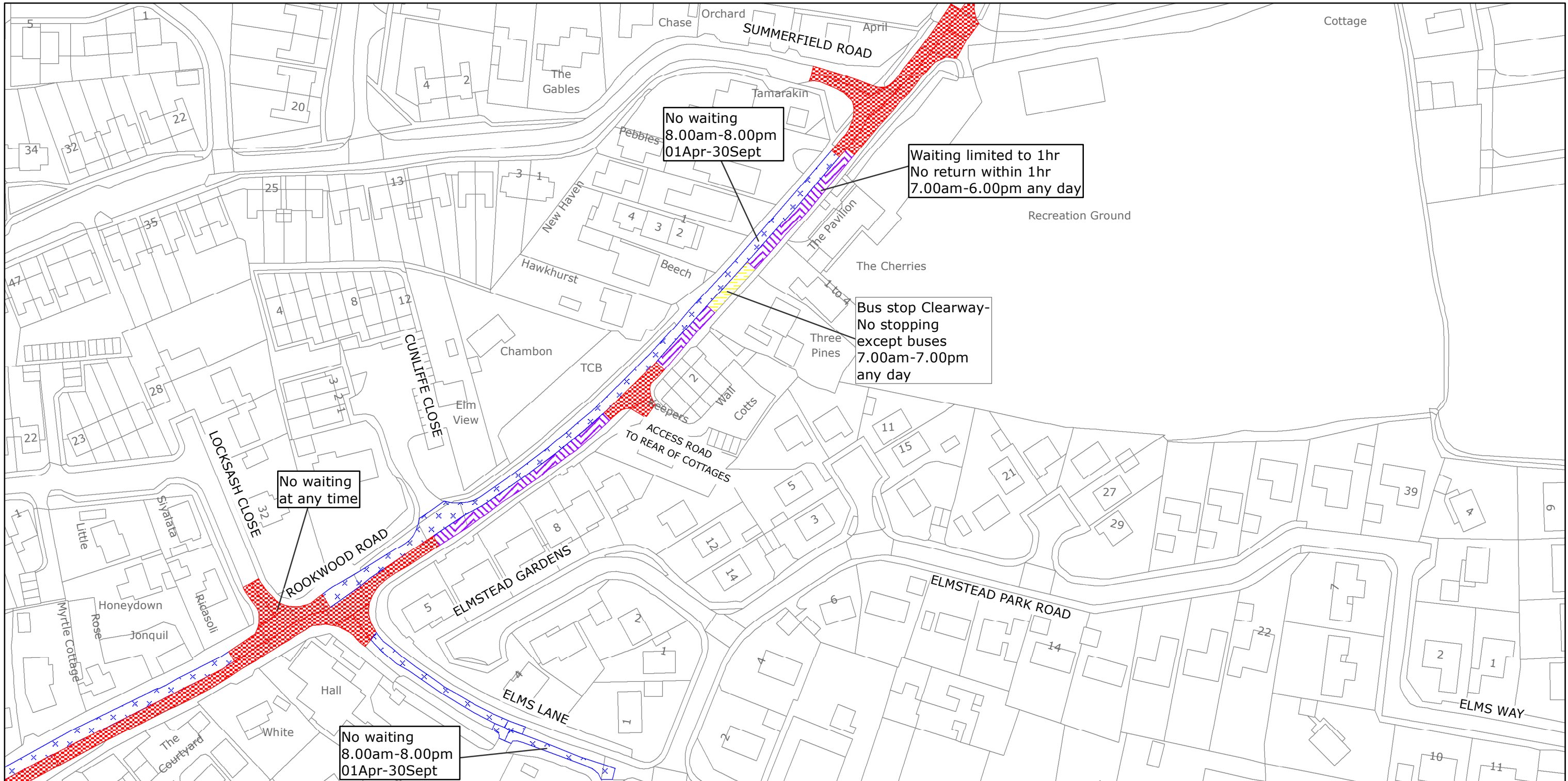

West Sussex County Council  
 Highways & Transport  
 The Grange  
 Tower Street  
 Chichester  
 West Sussex  
 PO19 1RH

CHICHESTER DISTRICT: WEST WITTERING  
 WAITING RESTRICTIONS

TILE REF NO:  
 SZ7898NWS

SHEET ISSUE NO 3  
 SHEET ACTIVE FROM - 03/12/2018



SCALE:  
 1:1250  
 at A3 size

Reproduced from or based upon 2018 Ordnance Survey mapping with permission of the Controller of HMSO (c) Crown Copyright reserved.  
 Unauthorised reproduction infringes Crown copyright and may lead to prosecution or civil proceedings West Sussex County Council Licence No. 100018485



West Sussex County Council  
 Highways & Transport  
 The Grange  
 Tower Street  
 Chichester  
 West Sussex  
 PO19 1RH

CHICHESTER DISTRICT: WEST WITTERING  
 WAITING RESTRICTIONS

**TILE REF NO:**  
**SZ7899SWS**

SHEET ISSUE NO 1  
 SHEET ACTIVE FROM - 03/12/2018



SCALE:  
 1:1250  
 at A3 size

Reproduced from or based upon 2018 Ordnance Survey mapping with permission of the Controller of HMSO (c) Crown Copyright reserved. Unauthorised reproduction infringes Crown copyright and may lead to prosecution or civil proceedings West Sussex County Council Licence No. 100018485